

MATCHLINE TO  
DRAWING SP-4.3

MATCHLINE TO  
DRAWING SP-4.3

INTERSTATE 84 (EASTBOUND)

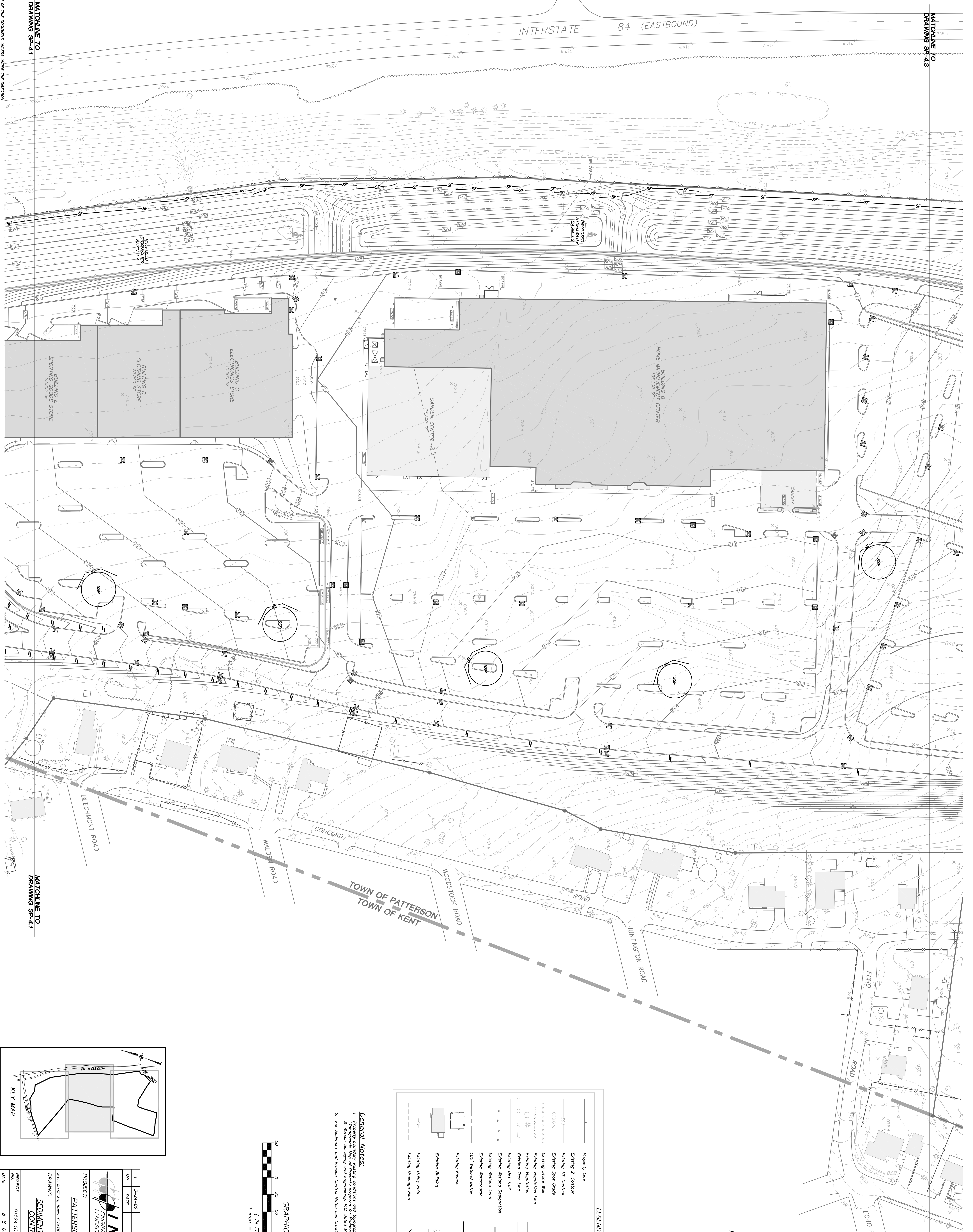

**LEGEND**

	Property Line		Existing Catch Basin
	Existing 2' Contour		Proposed Well
	Existing 10' Contour		Existing Sewer Easement
	Existing Spot Grade		Proposed Building
	Existing Stone Wall		Proposed Catch Basin
	Existing Vegetation Line		Proposed Concrete Sidewalk
	Existing Tree Line		Proposed Light Drainage Pipe
	Existing Wetland Limit		Proposed Rip rap Apron
	Existing Wetland Buffer		Proposed Silt Fence
	Existing Fence		Proposed Double Silt Fence
	Existing Utility Pole		Proposed Stone Check Dam
	Existing Grange Pipe		Proposed Stabilized Construction Entrance
	Proposed Silt Stockpile		

**General Notes:**

1. Property boundaries, existing conditions and topography shown herein taken from survey with the assistance of the following: **Walters, Wilson, & Wilson Surveying and Engineering, P.C.** dated May 14, 2001.
2. For Settlement and Erosion Control Notes see Drawing SP-4.2.

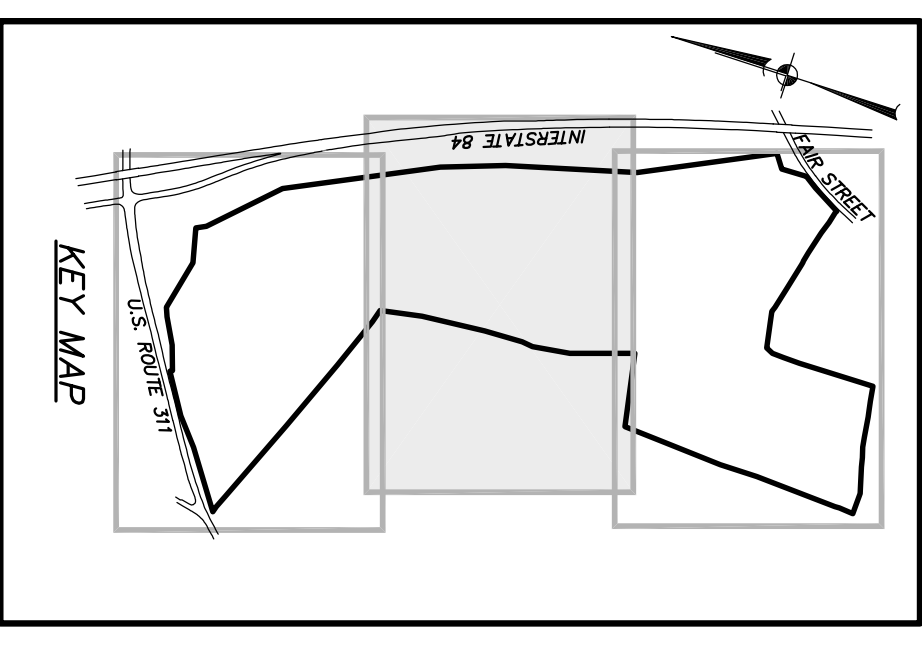
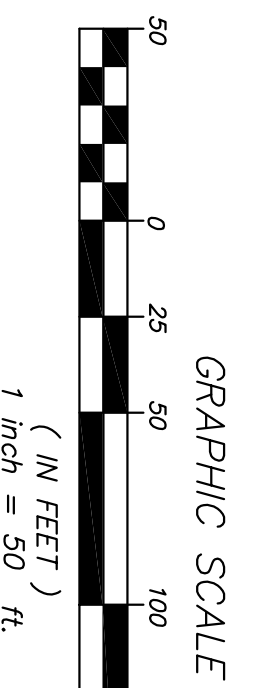

NO.	DATE	REVISION	BY
1	3-24-08	REVISED PER DSS COMMENTS	RCS

**PROJECT:** PATTERSON CROSSING

**DRAWING:** SEDIMENT & EROSION CONTROL PLAN

**CLIENT:** TOWN OF PATTERSON & TOWN OF KENT, PLANNING DEPT., NEW YORK

**ENGINEERING FIRM:** **INSITE** ENGINEERING, SURVEYING & LANDSCAPE ARCHITECTURE, P.C.

**PROJECT NO.:** 01124.100

**DRAWING NO.:** SP-4.3

**DATE:** 8-8-08

**SCALE:** 1" = 50'

**SHEET:** 12 / 19

APPROVED FOR THE ENGINEER, LICENSE NO. 10812, THE PROFESSIONAL ENGINEER, STATE OF NEW YORK, AND THE ARCHITECT, LICENSE NO. 10812, THE PROFESSIONAL ARCHITECT, STATE OF NEW YORK, AND THE SURVEYOR, LICENSE NO. 10812, THE PROFESSIONAL SURVEYOR, STATE OF NEW YORK.