

- Parking & Loading Notes:**
1. Required parking for retail use in the Town of Patterson is based on 1 parking space for each 200 square foot of building area.
 2. Required parking for retail use in the Town of Patterson is based on 1 parking space for each 200 square foot of building area, except for the Wholesale Warehouse and the Home Improvement Center, which are based on the following requirements:
 3. Section 154-23 of the Patterson Zoning Code permits the Planning Board to approve a variance for the Home Improvement Center and the Wholesale Warehouse.
 4. The Town of Patterson requires one (1) loading space at the first 5,000 SF of building area and additional loading spaces at each 20,000 SF interval for retail uses.
 5. The Town of Patterson requires one (1) loading space at the first 3,000 SF of building area and additional loading spaces at each 8,000 SF interval for retail uses.
 6. Building H and Building I are located in the Town of Kent. All other buildings are located in the Town of Patterson.

BUILDING AREA, PARKING AND LOADING TABLE

BUILDING DESIGNATION	BUILDING DESIGNATION	BUILDING AREA (SF)	REQUIRED PARKING	REQUIRED SPACES	PROPOSED SPACES
A	WHOLESALE WAREHOUSE STORE (4.5 SPACES/1,000 SF GFA)	148,000 SF	633 spaces	19	4
B	WHOLESALE WAREHOUSE STORE (4.0 SPACES/1,000 SF GFA)	138,200 SF *	541 spaces	18	4
C	HOME IMPROVEMENT CENTER (6.0 SPACES/1,000 SF GFA)	30,000 SF	150 spaces	5	2
D	WHOLESALE WAREHOUSE STORE (6.0 SPACES/1,000 SF GFA)	20,000 SF	100 spaces	4	2
E	WHOLESALE WAREHOUSE STORE (6.0 SPACES/1,000 SF GFA)	22,200 SF	111 spaces	4	2
F	WHOLESALE WAREHOUSE STORE (6.0 SPACES/1,000 SF GFA)	24,800 SF	124 spaces	4	2
G	WHOLESALE WAREHOUSE STORE (6.0 SPACES/1,000 SF GFA)	13,700 SF	69 spaces	3	2
H	WHOLESALE WAREHOUSE STORE (6.0 SPACES/1,000 SF GFA)	10,200 SF	51 spaces	1	1
I	WHOLESALE WAREHOUSE STORE (6.0 SPACES/1,000 SF GFA)	4,750 SF	24 spaces	0	1
TOTAL		405,850 SF	1,823 spaces required (1,888 spaces provided)	59	20

* Garden Center not included in building area.

SIGN TABLE

Designation	Type	Text	Size (Height x Width)	Area
F31	Free Standing (Town of Kent)	Patterson Crossing Home Improvement Wholesale Warehouse The Retailer	16' X 20' (Town Sign)	320 S.F.
F32	Free Standing (Town of Patterson)	Patterson Crossing Home Improvement Wholesale Warehouse The Retailer	22' X 24' (Town Sign)	528 S.F.
A1	Building Mounted	Wholesale Warehouse	10' X 36"	360 S.F.
A2	Building Mounted	Wholesale Warehouse	8' X 27"	216 S.F.
A3	Building Mounted	Wholesale Warehouse	8' X 27"	216 S.F.
A4	Building Mounted	Wholesale Warehouse	10' X 36"	360 S.F.
A5	Building Mounted	The Retailer	2' X 29"	58 S.F.
A6	Building Mounted	Home Improvement	2' X 14"	28 S.F.
B1	Building Mounted	Home Improvement	10' X 36"	360 S.F.
B2	Building Mounted	Home Improvement	8' X 27"	216 S.F.
B3	Building Mounted	Home Improvement	10' X 36"	360 S.F.
B4	Building Mounted	Home Improvement	8' X 27"	216 S.F.
B5	Building Mounted	Garden Center	2' X 14"	28 S.F.
B6	Building Mounted	Food Retailer	2' X 14"	28 S.F.
B7	Building Mounted	Conveyor Roll Up	2' X 14"	28 S.F.
C1	Building Mounted	Electronics Store	5' X 30"	150 S.F.
C2	Building Mounted	Electronics Store	5' X 30"	150 S.F.
C3	Building Mounted	Electronics Store	5' X 30"	150 S.F.
D1	Building Mounted	Clothing Store	5' X 30"	150 S.F.
D2	Building Mounted	Clothing Store	5' X 30"	150 S.F.
E1	Building Mounted	Sporting Goods Store	5' X 30"	150 S.F.
E2	Building Mounted	Sporting Goods Store	5' X 30"	150 S.F.
E3	Building Mounted	Sporting Goods Store	5' X 30"	150 S.F.
F1	Building Mounted	Home Goods Store	5' X 30"	150 S.F.
F2	Building Mounted	Home Goods Store	5' X 30"	150 S.F.
F3	Building Mounted	Home Goods Store	5' X 30"	150 S.F.
G1	Building Mounted	Directory Sign	3' X 20"	60 S.F.
H1	Building Mounted	Retail Store	3' X 20"	60 S.F.
I1	Building Mounted	Coffee Shop	2' X 15"	30 S.F.
I2	Building Mounted	Coffee Shop	2' X 15"	30 S.F.

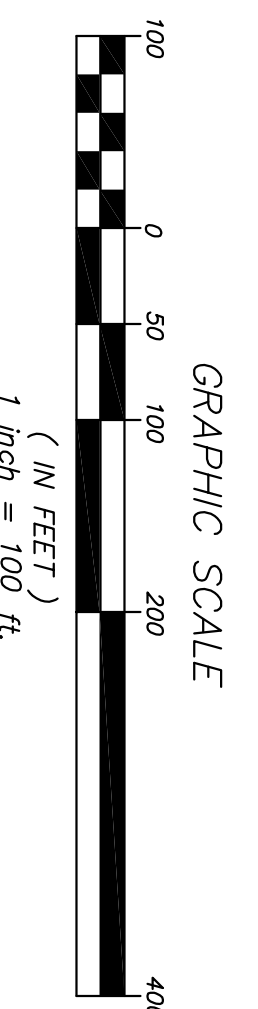
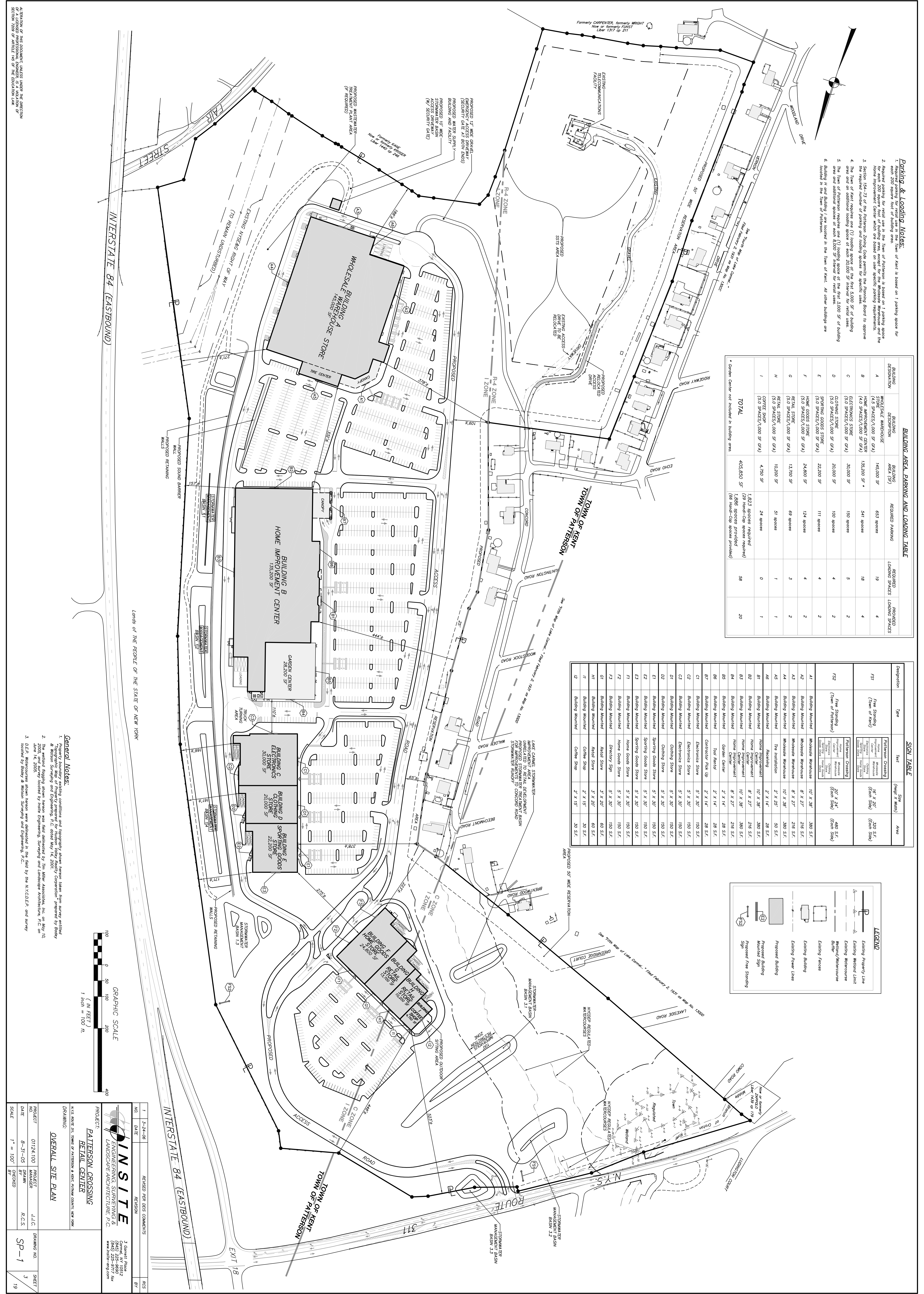
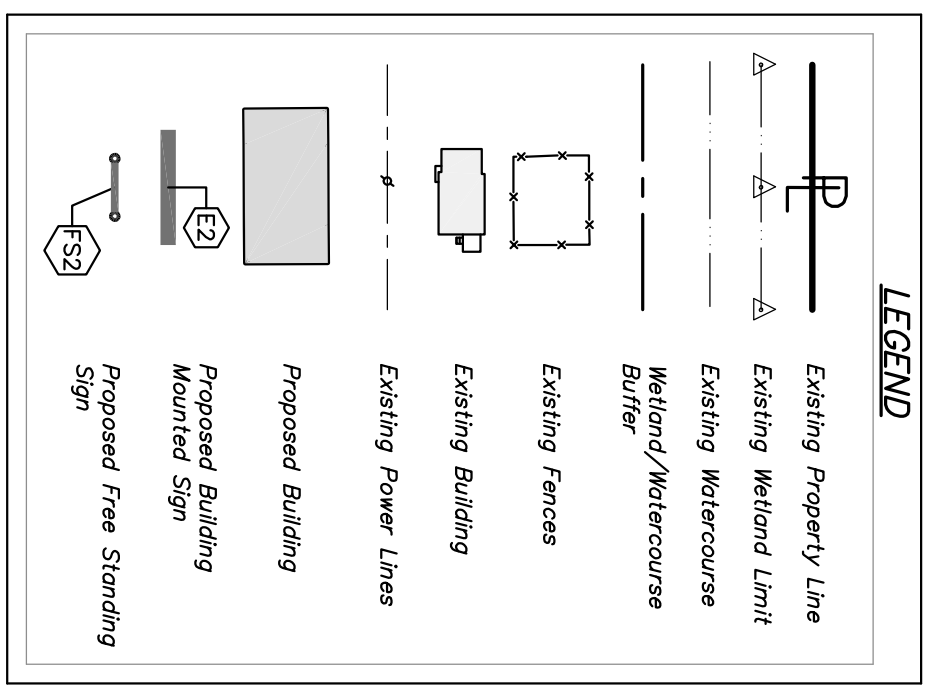

INSITE
ENGINEERING, SURVEYING &
LANDSCAPE ARCHITECTURE P.C.

3 General Place
Geneva, NY 10922
(518) 255-9717 fax
www.insite-ny.com

PROJECT: PATTERSON CROSSING RETAIL CENTER

DATE: 3-24-08

REVISION: REVISED PER DRS COMMENTS

DRAWN BY: J.L.C.

CHECKED BY: R.C.S.

SCALE: 1" = 100'

SHEET: SP-1

TOTAL SHEETS: 3

APPROVED BY THE ENGINEER, LANDSCAPE ARCHITECT AND ARCHITECT OF A LICENSED PROFESSIONAL ENGINEER OR A QUALIFIED ARCHITECT UNDER THE SUPERVISION OF THE ENGINEER, LANDSCAPE ARCHITECT OR ARCHITECT.

SECTION 2209 OF ARTICLE 14B OF THE EDUCATION LAW